

REFERENCES

- 479A60*** - 1 kit of 2 tags for FLT with Skincolor
- 479C60*** - 1 kit of 2 tags for FLT without Skincolor
- 47A060000 - 1 kit of 4 templates for FLT with Skincolor
- 47A160000 - 1 kit of 3 templates for FLT without Skincolor

METALIC STRUCTURE

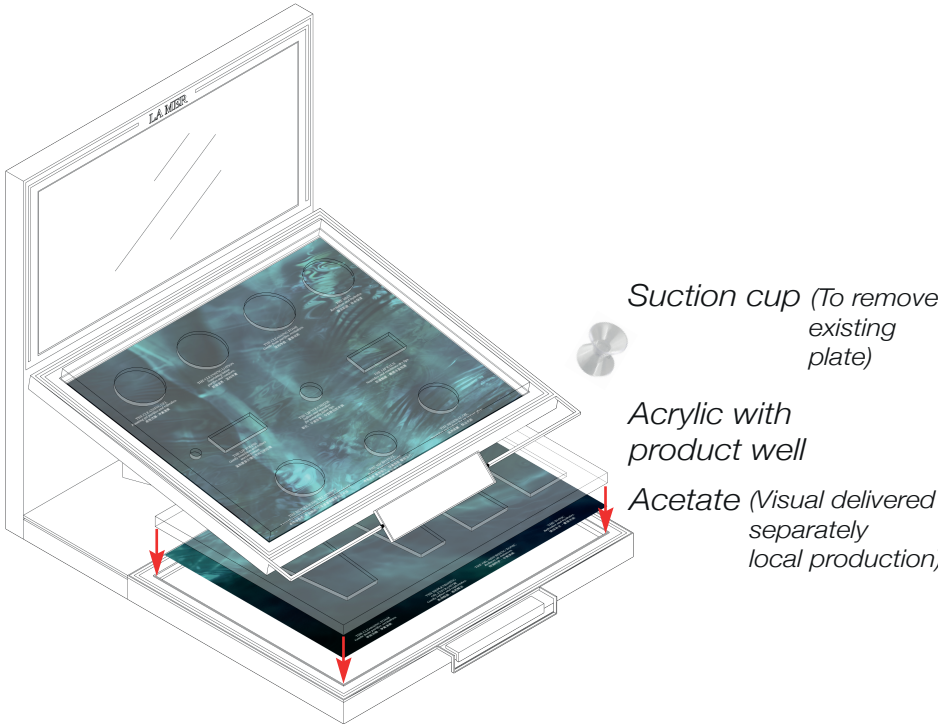
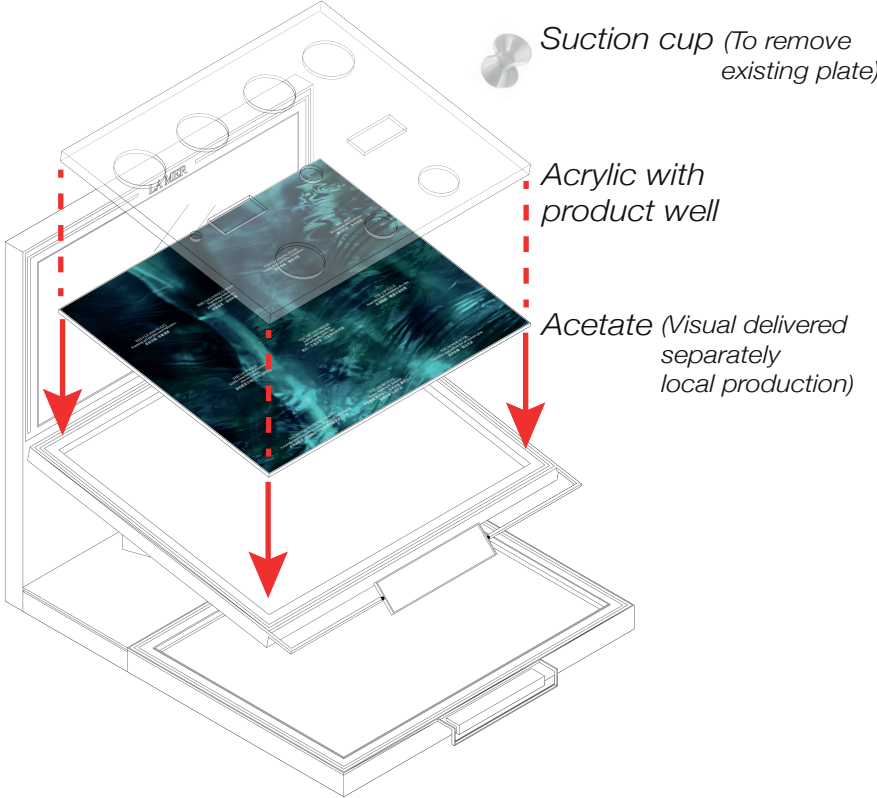
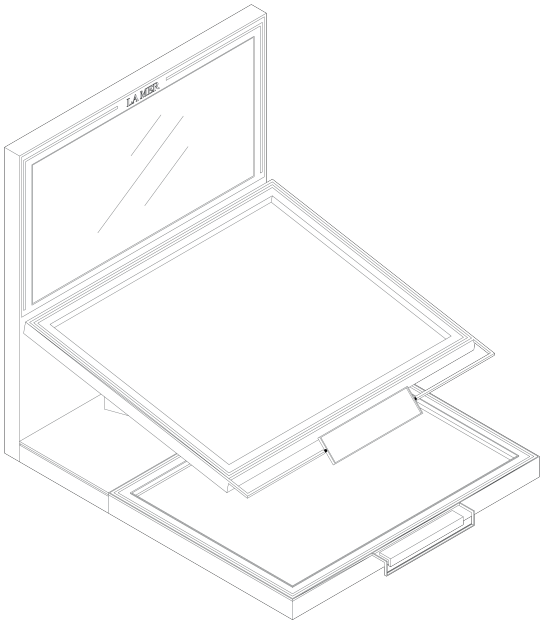

Step 1:
Remove the existing plate with suction cup. Stick the suction cup on the existing plate and pull.
Then update the new acetate visual on the structure then place acrylic with product well.

ACRYLIC PLATE

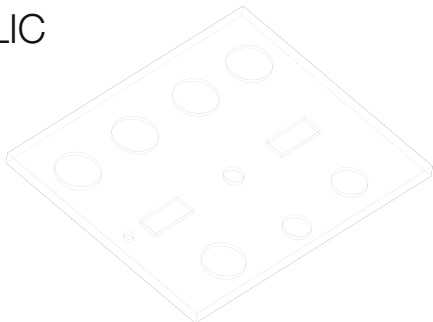

SMALL CLEAR SUCTION CUP
(TO REMOVE THE PLATE/TAG)



ACETATE

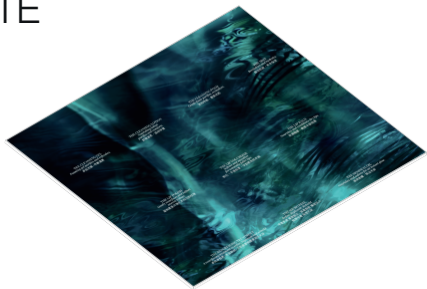

TAG



REFER FULL LINE TESTER
FY23-2H PLANOGRAM
FOR AN ACCURATE DISPLAY
ACCORDING TO YOUR POS.

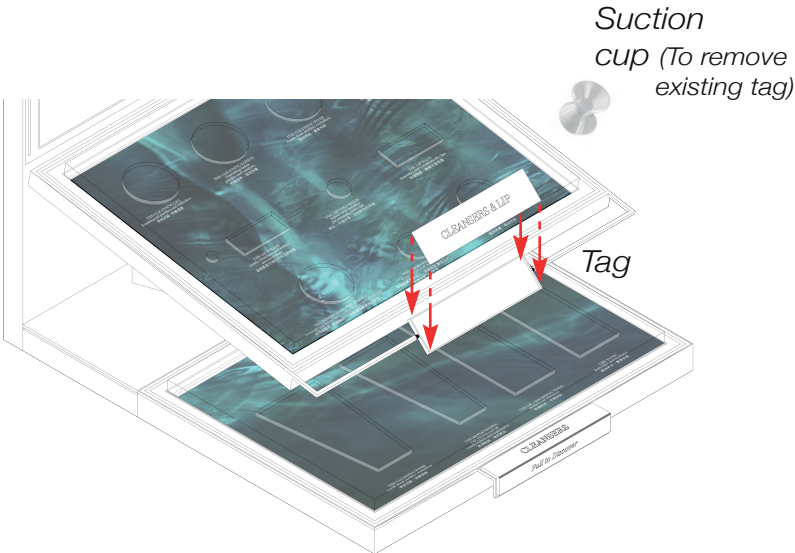
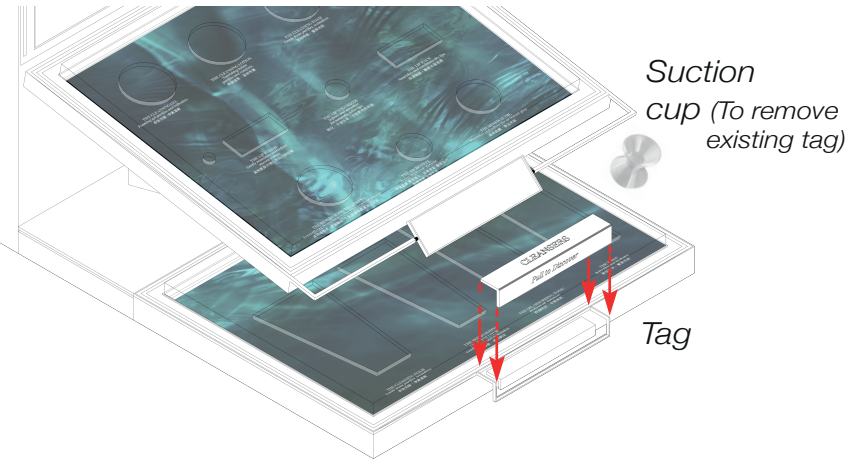

Step 2:
Remove the existing tag with suction cup. Stick the suction cup on the existing tag and pull.
And Install new tag on the structure, use the magnetic inside of tag to attach.